

MELS

MELS 3 — STAGE L

100' x 100' x 38' High (Grids)
(10,000 sq ft/929 m²)

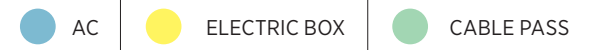
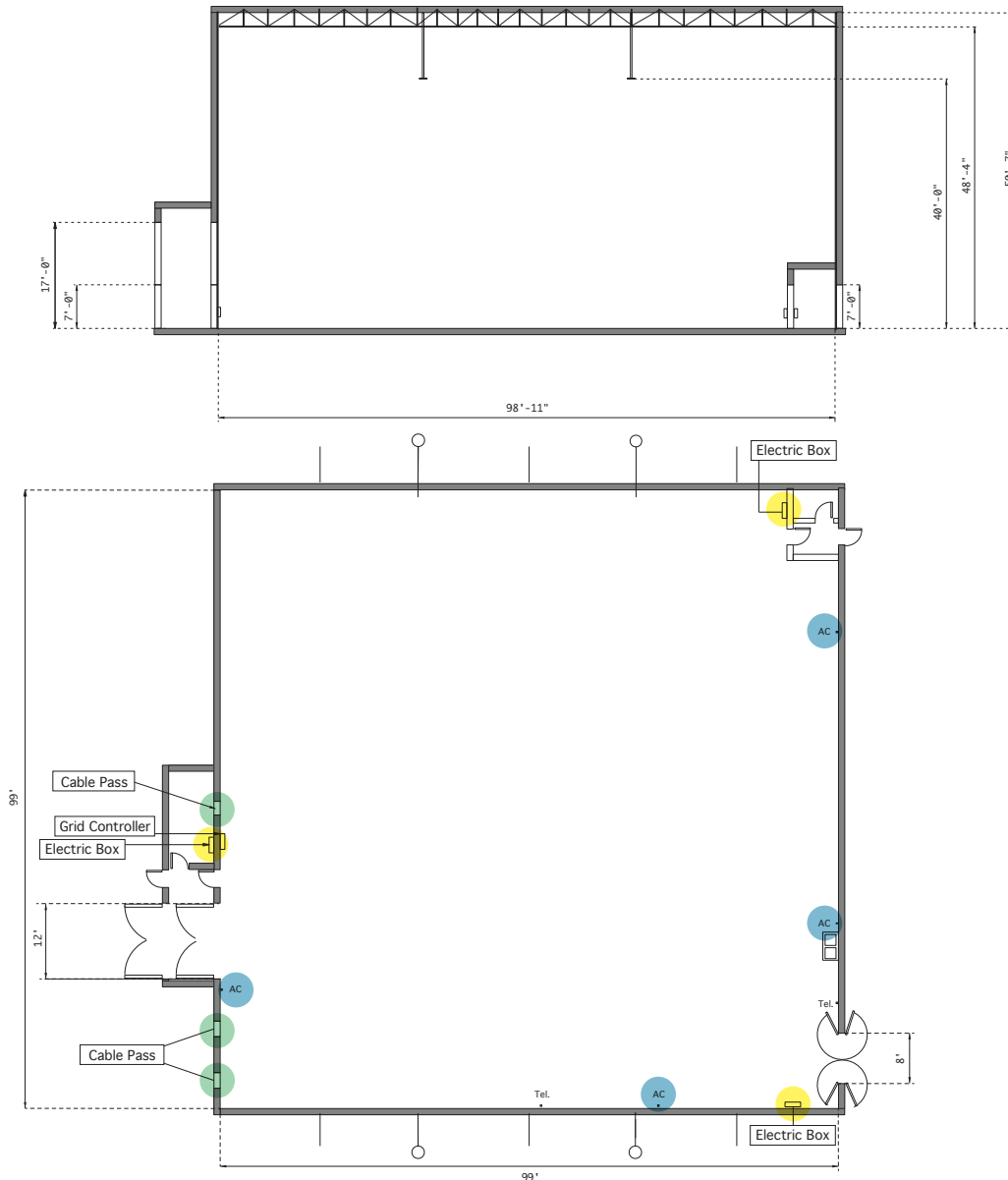

CAPACITY LOAD

MOTHER BEAM

Live Load: **48 lbs/sq ft**

Dead Load: **26 lbs/sq ft**

Only one point: **3,000 lbs**

Two points at 8' c/c: **2,000 lbs per point**

Total foot/linear load: **119.76 lbs**

RAFTERS

Only one point: **6,000 lbs**

Two points at 8' c/c: **3,000 lbs per point**

Total foot/linear load: **840 lbs**

FLOOR

Weight capacity: **200 lbs/sq ft**

Anchor depth max. = **6 in**

ELECTRIC

3 X 300 amp 120 - 208V - 3ØY

Max Capacity: **2,700 amp (100%)**

Continuous demand at **80%**

Periodic demand at **100%**

